

Benodigde aansluitingen:

- 380V 32A 5-polig nul aangesloten.  
Maximale afstand aansluiting t.o.v. DX200 controller = 4m.
- Perslucht 7 bar. Insteekkoppeling voor slang ø8mm.
- Netwerkkabel. Deze moet bij de DX200 controller kunnen komen +2 meter overlengte.

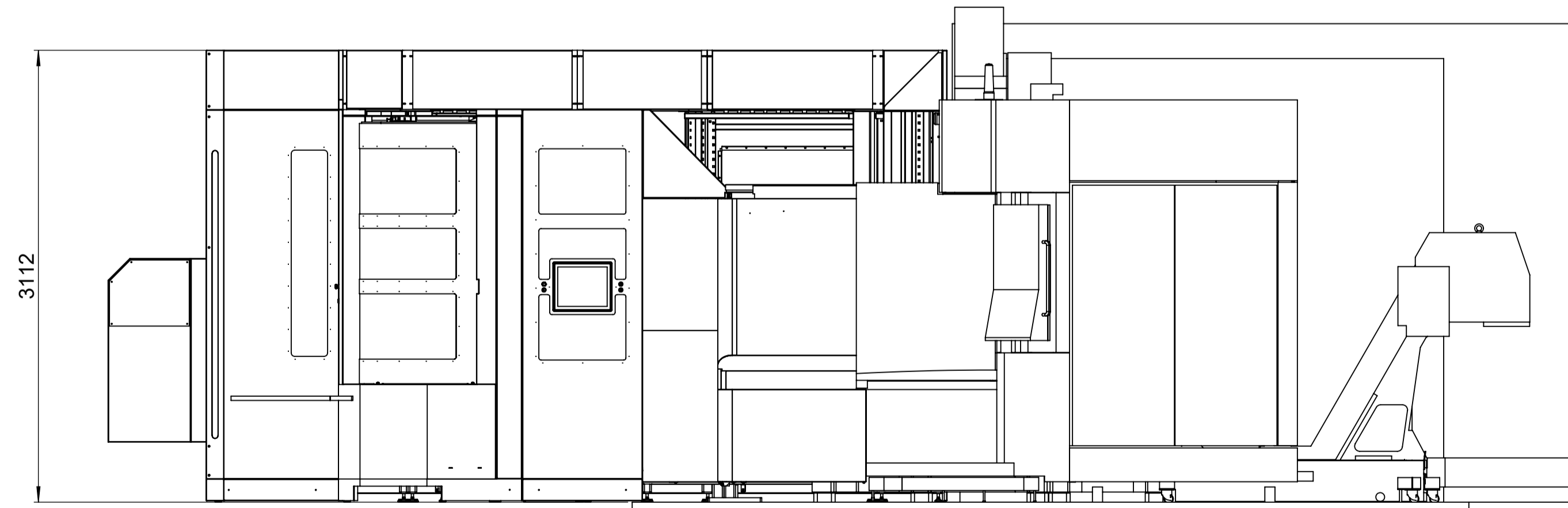
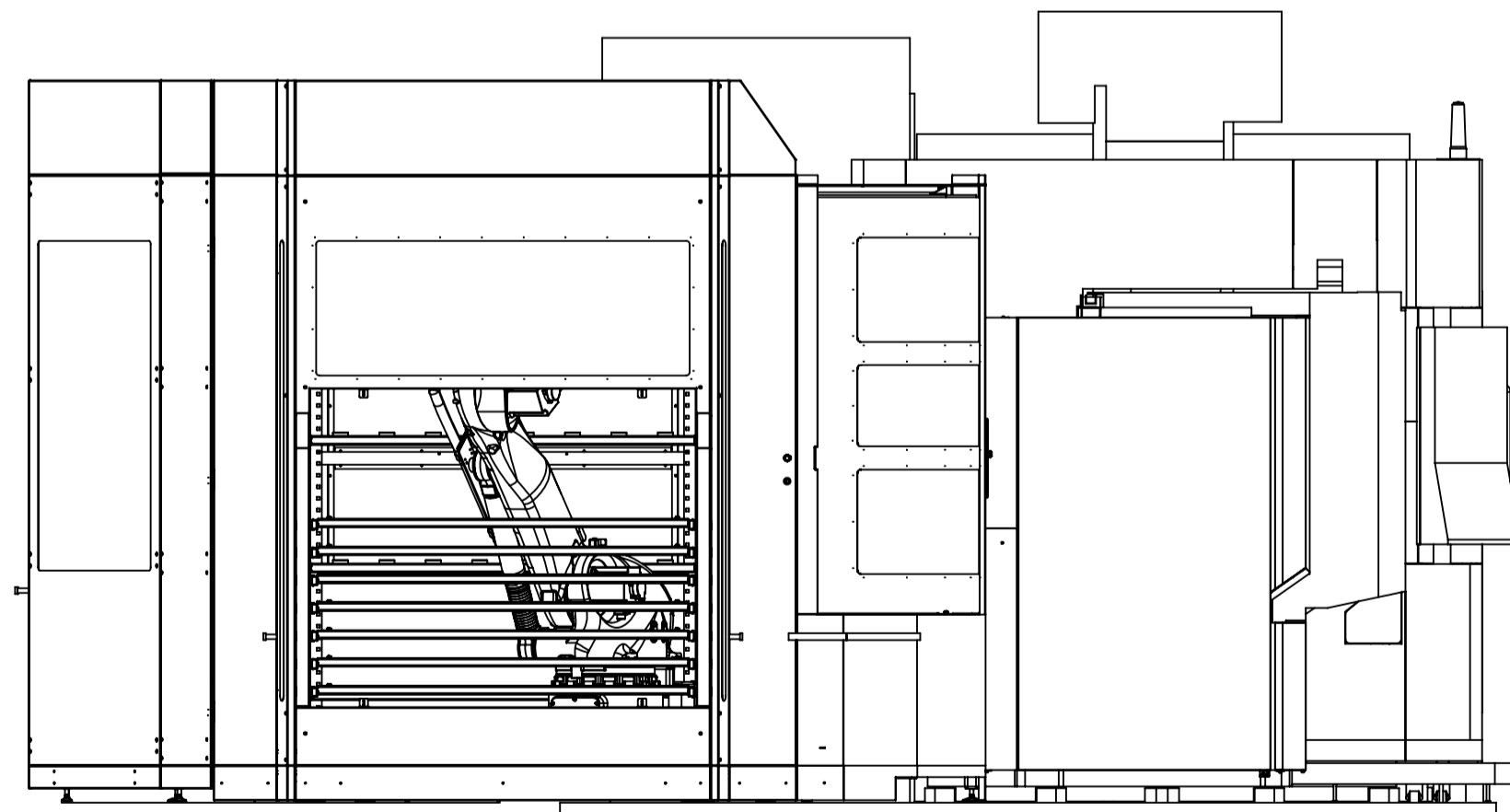
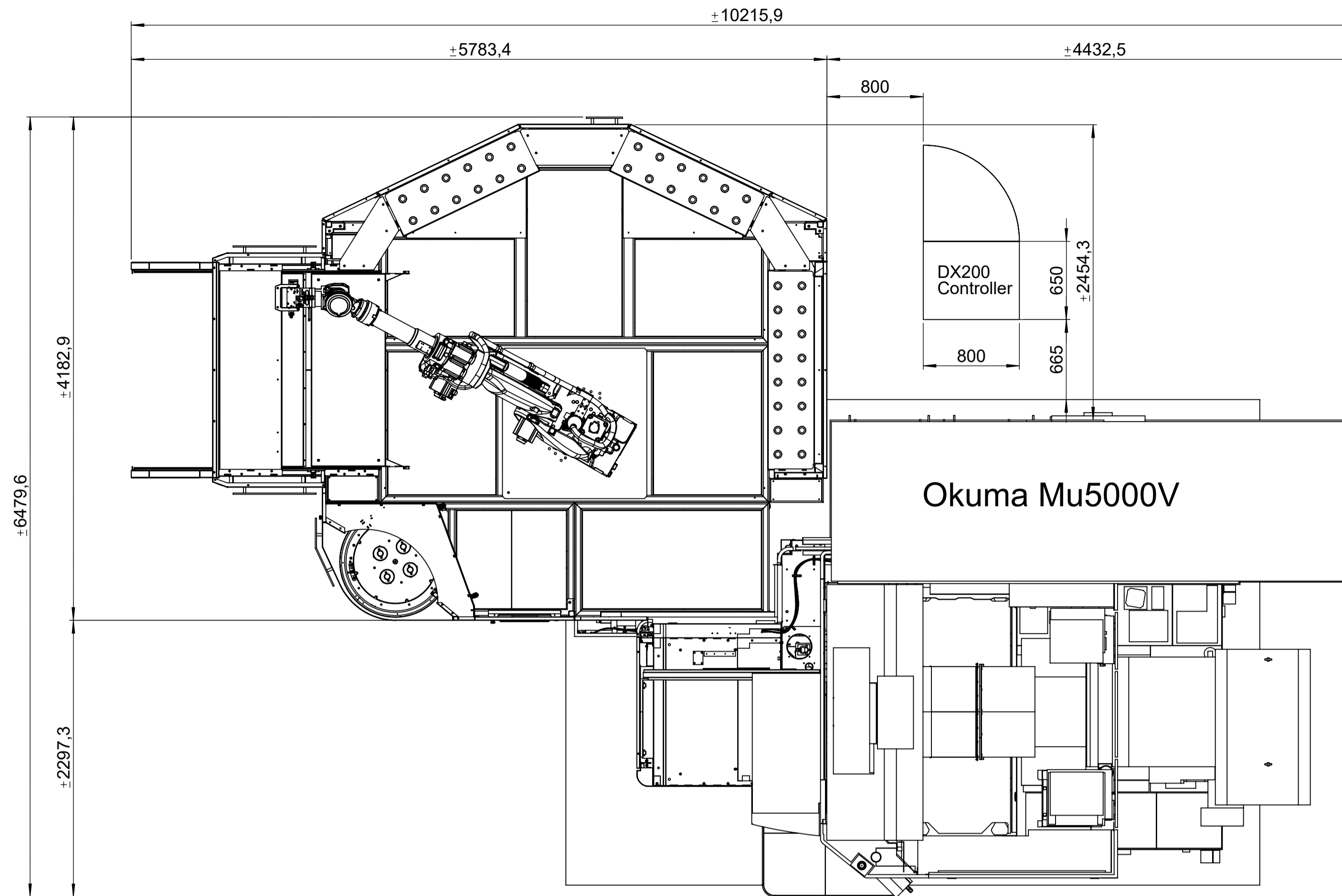
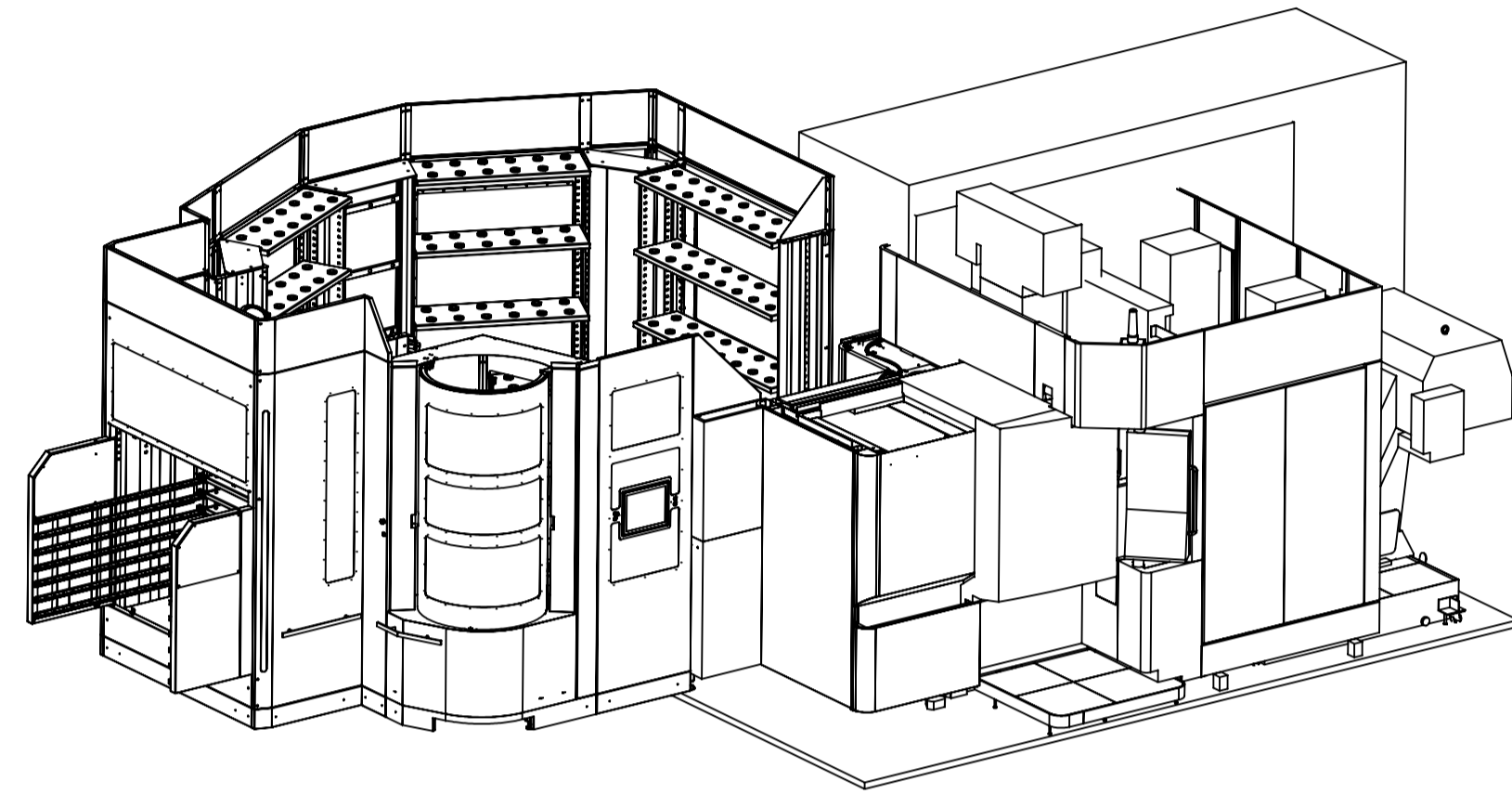

Description: Titanium 180 - Okuma MU-5000V (Pallet & Product loading)		Drawn : B.P.	Project :
Material: See mono's		Date : 27-3-2018	American projection
Treatment:		Status :	Weight : 0.00 kg
Scale : 1:30		Sheet No. : 1/1	
 BMO Automation T : +31 (0) 495 622437 info@bmoautomation.nl www.bmoautomation.nl		Dimensional tolerances according to ISO 2768-mK	A1
		Roughness according to EN-ISO 1302	
Drawing no. 1004153		Revision 0	